



Cornflower Button Tutorial

This cornflower button is designed to fit in the center of the Cornflower Biscornu, a pretty cushion shape based on a cross stitch pattern designed by Faby Reilly

You will need:

- Fimo paste in the following colours: blue (no. 37), white (no. 0), red (no. 26) and purple (no. 604)
- A little heart-shaped cutter
- Some baking paper
- A wooden cocktail stick



1. Mix a little white paste with some blue, and add a tiny amount of red to give it a slightly lavender coloured shade. When done, you'll need 3 shades: dark blue, lavender blue, and light purple.

Do bear in mind that the cooking process darkens the colours.



2. When you're happy with your colours, mix them roughly together (so that you can still see the different shades), and make a ball out of it all. Spread your paste out until you get a disk about 2 or 3 mm thick. With the heart shaped cutter, cut out 5 hearts.

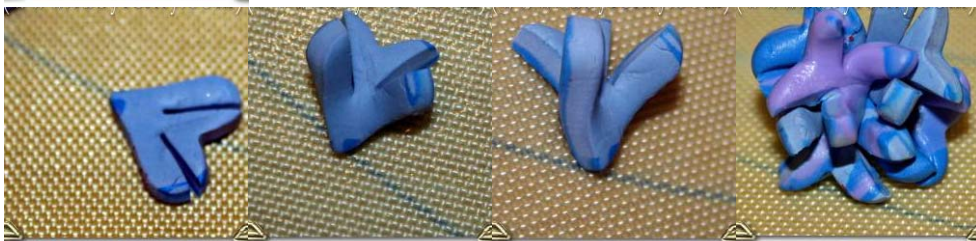

3. Shaping: Cut 2 lines along each heart (as shown on the picture), and lift up the sides in order to space out the "petals". Gather the 5 hearts into a bunch. Try to aim for the purple shades in the centre and the darker blue on the outside.

Place your cornflower in the refrigerator for at least 1 hour to cool and harden the paste.

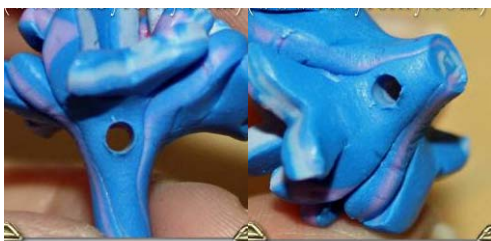

4. Once the paste is hard enough to be handled without getting out of shape, carefully drill a hole through the stem of the cornflower using your wooden cocktail stick. Then cut off the stem using a sharp knife.



5. Lay your cornflower on a baking tray lined with baking paper, and put it in the oven following the manufacturer's instructions (usually 30min at 110°C/230°F).

Leave aside to cool, then varnish the petals with a clear varnish. When dry, glue a few beads in the centre of the flower using clear liquid craft glue.

You're done!



More patterns designed by Faby Reilly



Violets Biscornu



Lavender Needlebook



Poppy Bookmark



Sweet Roses Heart



Butterfly Scissor Case



Cornflower Biscornu



Plum orchid Biscornu



Lavender Bouquet Pouch



Plum Orchid Needlecase



Sepia Rose Biscornu



Snowman Biscornu



Poppy Biscornu

View these patterns and many more on Creative Poppy's website

www.creativepoppy.com